

## SNOWDOZER TYPE SCH-L



	Blade width in mm	Clearing width (adjustable) in mm	Blade height in mm	Weight in kg (painted/galv.)
SCH-L 1500	1500	1500 / 1300	585	120 / 129
SCH-L 1800	1800	1800 / 1550	585	129 / 139

### An economic alternative

- fast pick-up: insert forks
- can be secured to prevent slipping
- adjustable blade - to the right or to the left
- rubber scraping edge screwed to the blade; quick change possible
- spray painted **RAL 2000**  
or **hot-dip galvanized**
- Replacement scraping edges  
1500 x 150 x 20 mm (SCH-L 1500)  
1800 x 150 x 20 mm (SCH-L 1800)

#### Fork sleeve inside dimensions in mm

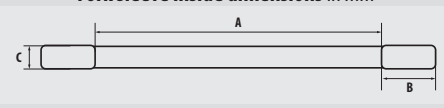

	A	B	C
SCH-L 1500/1800	410	168	68

## SNOW PLOUGHS TYPE SCH-P / SCH-U



SCH-P-S

### This sturdy snow plough automatically compensates uneven surfaces

- pendulum suspension
- shock absorbers
- uneven surfaces are no problem
- easy on the mast
- variable ground leeway thanks to adjustable runners
- adjustable blade; 2 positions, to the right and to the left
- scraping edge screwed to the blade; quick change possible
- spray painted **RAL 2000**



SCH-U-S

### Types available

#### SCH-P

- fork sleeves above blade

#### SCH-U

- fork sleeves close to the ground

#### ...-S

steel scraping edge

#### ...-G

rubber scraping edge

#### ...-V

polyurethane scraping edge

#### Fork sleeve inside dimensions in mm

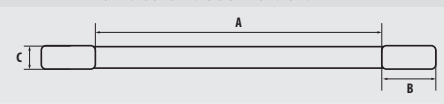

	A	B	C
SCH-P/-U 150-180	412	165	60
SCH-P/-U 210-240	412	215	75

	Blade width in mm	Clearing width (adjustable) in mm	Blade height in mm	Weight in kg		
				Type ...-S	Type ...-G	Type ...-V
SCH-P 150 / SCH-U 150	1500	1500/1300/1100	620	195	200	197
SCH-P 180 / SCH-U 180	1800	1800/1600/1300	620	206	212	209
SCH-P 210 / SCH-U 210	2100	2100/1800/1500	620	228	235	231
SCH-P 240 / SCH-U 240	2400	2400/2100/1700	620	252	260	256